

A Special Mountain Way Common Thank You!

The Friends of Mountain Way Common, LBI, and PP+D would like to take this opportunity to express our collective gratitude to all the residents that participated in the Mountain Way Common Conceptual Design Process. Your time, creativity, and passion is greatly appreciated and we look forward to continuing to work with you to fully realize Mountain Way Common

Master Planning Participants

Marvin Pastel	Nick Hume	James Hernandez
Daniel R. Weede	Janice Hume	July Hernandez
Gordon Certain	Kevin McCauley	Lacy Hernandez
Jane Moss	Shelli Keagle	Valerie Sellers
Jane Zoellick	Ammar Divan	Susan Richards
Marianna Lee	Steve Inskeep	Chad Richards
Wendy Castro	Mandy Lecompte	Edward Castro
Sharon Rudy	M. Keagle	Anne Marie Mueller
Harvey Rudy	Hayden Sumlin	Marcus Rammers
Katherine Reed	Ian Balish	K. Walts
Janice Hume	Riley Hernandez	

Project Management Team

Marvin Pastel, Friends of Mountain Way Common
Denise Starling, Livable Buckhead

Planning + Design Consultant

Carlos F. Perez, Perez Planning + Design, LLC
Abhishek Behera, Perez Planning + Design, LLC

Mountain Way Common

Vision +
Implementation
Strategy



www.mountainwaycommon.org



3340 Peachtree Road
Suite 1640
Atlanta GA 30326
P 404 824 2680
www.livablebuckhead.com

PEREZ PLANNING + DESIGN, LLC

878 Peachtree Street, NE | Suite 827 | Atlanta GA 30309
P 404 416 0114 | www.perezpd.com

Mountain Way Common is one of the most unique and progressive greenspaces in Metro Atlanta. Partially located under a monumental highway overpass and along the Nancy Creek, Mountain Way Common draws inspiration from a handful of parks across the United States that transform forgotten Department of Transportation bridge overpass lands into livable greenspaces. Mountain Way Common reconnects a neighborhood divided by the construction of the GA 400 Highway by transforming 9-acres of underutilized and antagonizing land in the most under-parked community in the City of Atlanta into much needed usable greenspace and amenities for area residents.

The Friends of Mountain Common, Livable Buckhead, Inc. (LBI), and Perez Planning + Design, LLC (PP+D) partnered to work collaboratively with neighborhood residents to develop an update to the Mountain Way Common Conceptual Master Plan.

The master planning process was led by the Friends of Mountain Way Common Board. The process included two public charrettes where the Friends of Mountain Way Common and neighborhood residents worked collaboratively to identify unique park zones and develop guiding principles, objectives, and desirable programs and activities that informed the update to the Conceptual Master Plan.

Moving forward, the neighborhood, in partnership with LBI will actively work to raise money for the development of construction documents and capital improvements, as well as work with residents and volunteers to realize the greenspace. The realization of Mountain Way Common will provide a multitude of economic, social, and environmental benefits including increased property values; access to the PATH 400 Trail; traffic calming; physical, emotional, and mental health and wellness; cultural exchange, social resiliency; and environmental awareness, preservation, and stewardship.

Mountain Way Common Guiding Principles

Safe + Secure

Mountain Way Common will be designed as a welcoming greenspace that can be safely and comfortably enjoyed by users of all ages, genders, ethnicities, and capabilities.

Engaging + Sustainable

Mountain Way Common will be designed to facilitate meaningful interactions with nature that enhance and preserve the environment for existing and future generations to enjoy.

Contextual

Mountain Way Common will be designed to be responsive to its surrounding residential, natural, and infrastructure environment.

Communal

Mountain Way Common will be designed to serve as an inviting gathering space that can be enjoyed and shared with all members of the neighborhood.

Peaceful

Mountain Way Common will be designed to facilitate and foster harmonious and tranquil enjoyment of the greenspace.

Authentic

Mountain Way Common will be designed using unique and site-sensitive details and amenities that provide a unique and genuine experience.

Casual

Mountain Way Common will be designed to allow users to enjoy a relaxed, friendly, and informal experience.

The Colonnade climbing + exercise area - \$491,000



C East Nature Common - \$340,900

Entrance plaza + pavilion - \$242,400



Amphitheater + firepit - \$98,500



D Playground Common - \$1,912,500

Splash pad + picnic shelter + restroom - \$860,000



Shaded playground + landscape sitting area - \$1,052,500



Mountain Way Common Implementation Strategy

The realization of Mountain Way Common is estimated to cost approximately \$4.5 million. The implementation of the greenspace will consider all available public, private, and philanthropic funding sources. The Friends of Mountain Way Common have already invested close to \$200,000 and thousands of volunteer hours towards the realization of the greenspace.

A West Nature Common - \$272,000

Treehouse + adventure play area - \$272,000



Common's access+circulation - \$630,500

The Common's neighborhood greenway - \$390,500



The Common's nature and creek path - \$64,500



The Common's paved path - \$175,500



B Colonnade Common - \$801,600

The Colonnade slides - \$310,600



Desirable Mountain Way Common Program + Activities



Food trucks



Goats



Art festival/ temporary pieces



Fall Festival



Halloween gathering



Midnight run



Fitness station



Walking path



Temporary art



Treehouse/ adventure playground



Rock/ sculpture climbing



Playground with slides, swings, sail canopy



Movable tables and chairs



Plaza space for people to gather/ staging area with a shelter/gazebo



Amphitheater with a fire pit

Mountain Way Common Conceptual Master Plan

The unique location, topography, and character of Mountain Way Common, in conjunction with the greenspace desires of neighborhood residents provide for an opportunity to design the space around four unique zones:

1. West Nature Common
2. Colonnade Common
3. East Nature Common
4. Playground Common

Each of these zones contains a variety of spaces, facilities, and amenities that allow residents of all ages and abilities to enjoy a range of social, cultural, recreational, and environmental activities and experiences.

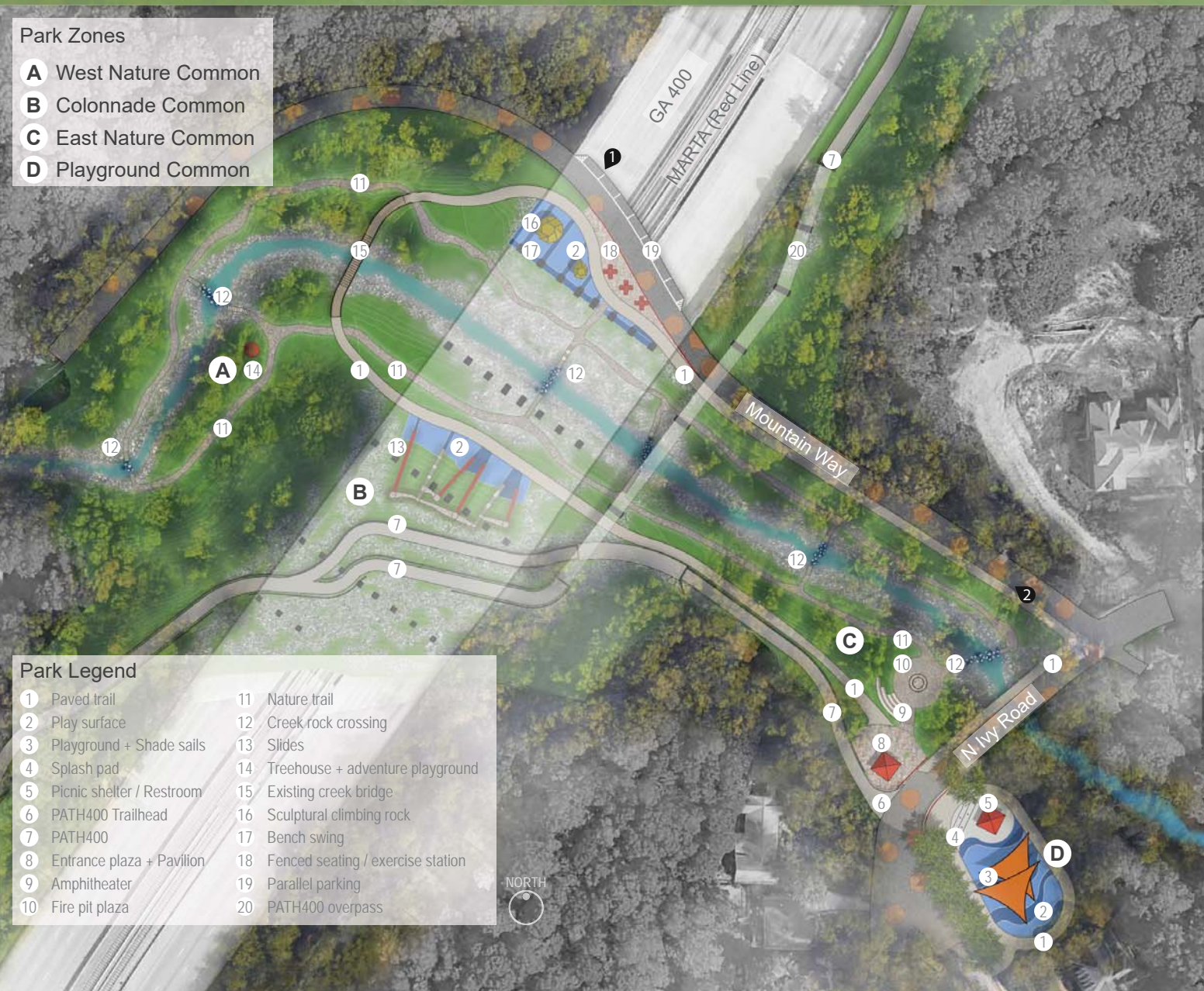

1 Colonnade Common
The Colonnade Common transforms a unique space that is protected from the sun and the rain into a usable space where residents can comfortably and safely enjoy a variety of social and leisure experiences.

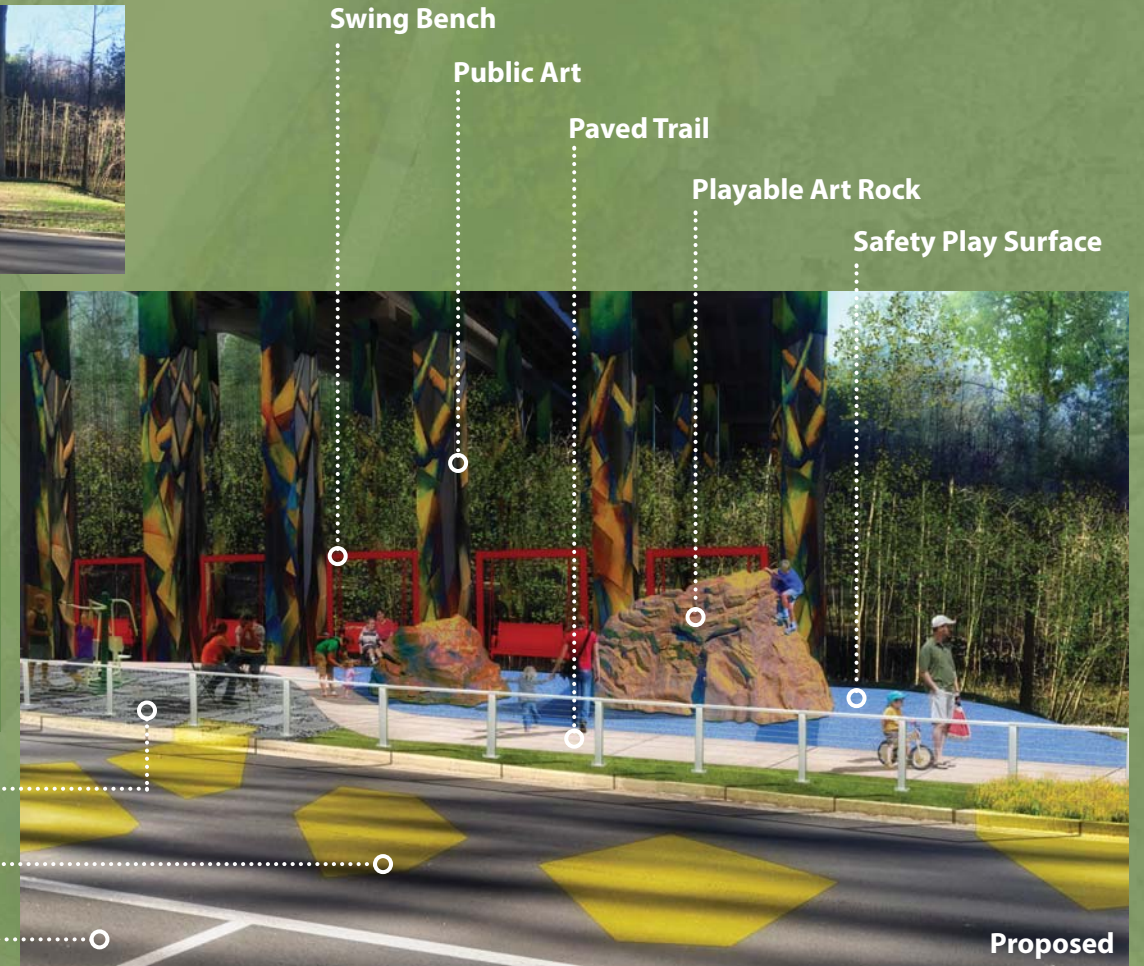

- Outdoor Fitness Stations + Movable Tables + Chairs
- Traffic Calming Street Art
- On-Street Parking



2 East Nature Common
Located along the north edge of the East Nature Common is a Neighborhood Greenway that is part of the paved trail circling the greenspace, which limits impact to the natural environment by using the roadway to create a safe corridor for pedestrians, cyclists, and vehicles to co-exist.

